

1050 Series Stainless Steel

Heavy duty stainless steel floor access covers for internal and external hard floor finishes

Features

- Specifically designed for use in external pedestrianised areas where vehicular access is required
- Covers can be fitted quickly and unobtrusively into all types of hard floor finish: concrete or natural stone
- Unique cover sections are tapered for easy removal, and frame sections give good key to bedding mortar. Covers are precision-made to avoid distortion
- Double seals are available.
- Lifting blocks are anchored to the inner frame. Stainless steel securing bolts are stiletto heel proof.
- Quality control to BS EN ISO 9001.

General notes on 1050 series floor access covers

Size - All covers are made to measure. This allows the manufacture of any size between the stated maximum and minimum dimensions. Sizes that may be thought 'non-standard' can therefore be obtained without delay and without cost surcharge. The versatile nature of the Howe Green system allows any configuration of ducts and branches to be created.

Weight - The weight of the access cover should be taken into account where ease of handling is an important consideration. In all cases reference should be made to the Manual Handling Operations Regulations 1992, which implement European Directive 90/269/EEC. If loads are excessive, consideration should be given to the use of hydraulic lifters.



1050 Series Stainless Steel Single Cover

Typical floor finishes

External grade paving slabs including granite and concrete.

Performance

Up to 6.5 tonne pneumatic tyre wheel load (C250).

Options

Double seal. Inset lifting points.

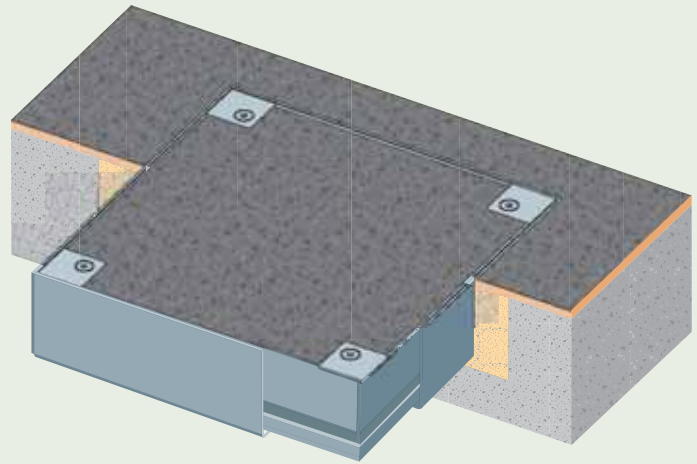

Cross section showing concrete sub-floor

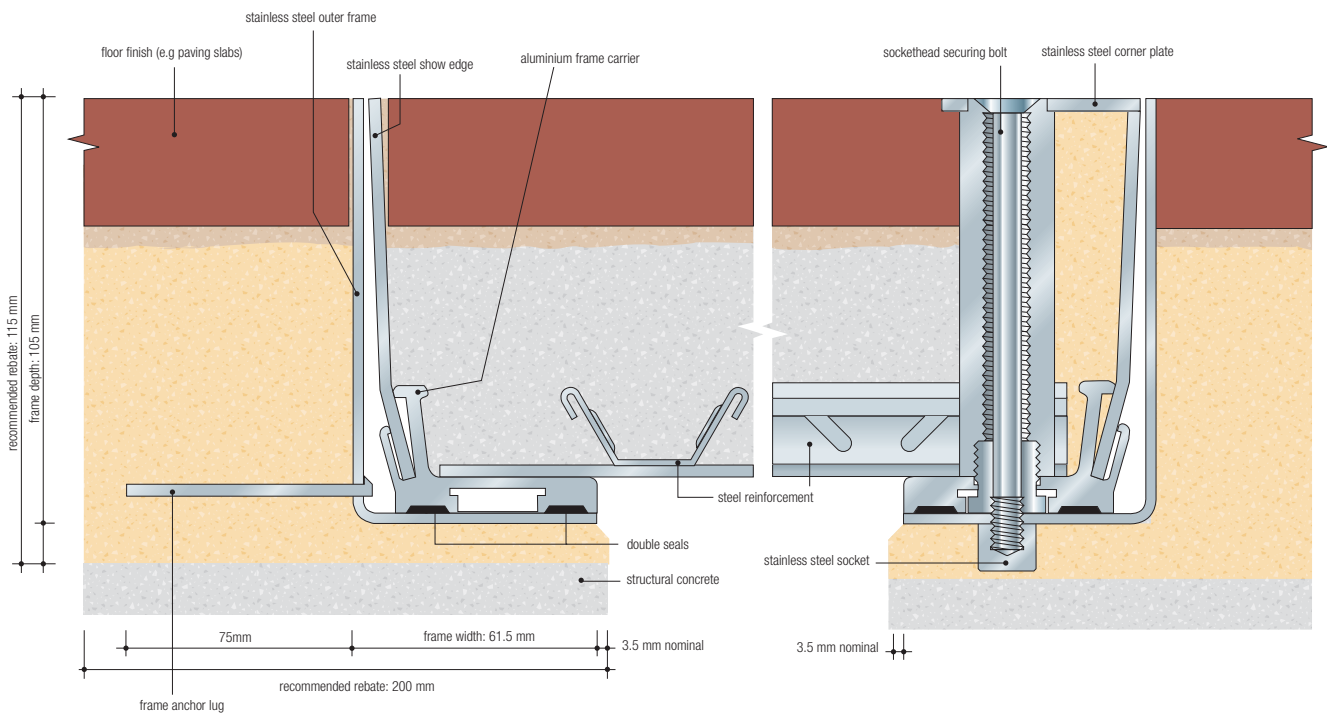

Typical specification clause for 1050 series

Recessed floor access/ duct/ multipart* covers and frames shall be Howe Green Ltd 1050 series, stainless steel with stainless steel/steel* base plate and reinforcement, double sealed with socket head securing bolts/ unsealed with blanking bolts*. Sizes shall be as shown on contract drawings nos† Covers to be supplied complete with† sets of combined lifting/ securing keys. All to be manufactured and supplied by Howe Green Ltd, Marsh Lane, Ware, Hertfordshire, SG12 9QQ, Great Britain, and installed in accordance with the manufacturer's installation details and sitework guide.

* Delete as appropriate. † Insert appropriate numbers & quantities

Size

Overall frame size = clear opening + 130 mm e.g. 600 x 900 mm clear opening = 730 x 1030 mm overall frame. Subject to correct infill/installation (see separate guide). See also general

Weight

A 1050 series cover when filled with concrete weighs approx. 220 kg/m². See also general notes on cover.

Maximum / minimum sizes

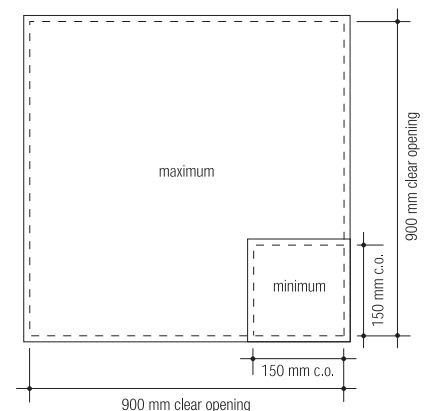

1050 Series Stainless Steel Duct Cover



Typical floor finishes

External grade paving slabs including granite and concrete.

Performance

Up to 6.5 tonne pneumatic tyre wheel load (C250).

Options

Double seal. Inset lifting points.

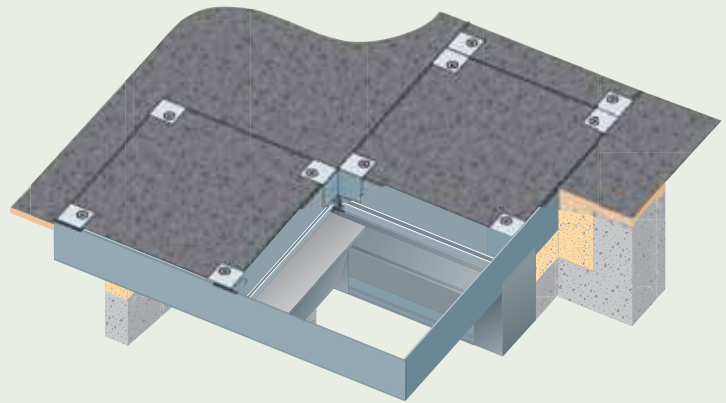

Cross section showing anchor lugs and locking/lifting detail

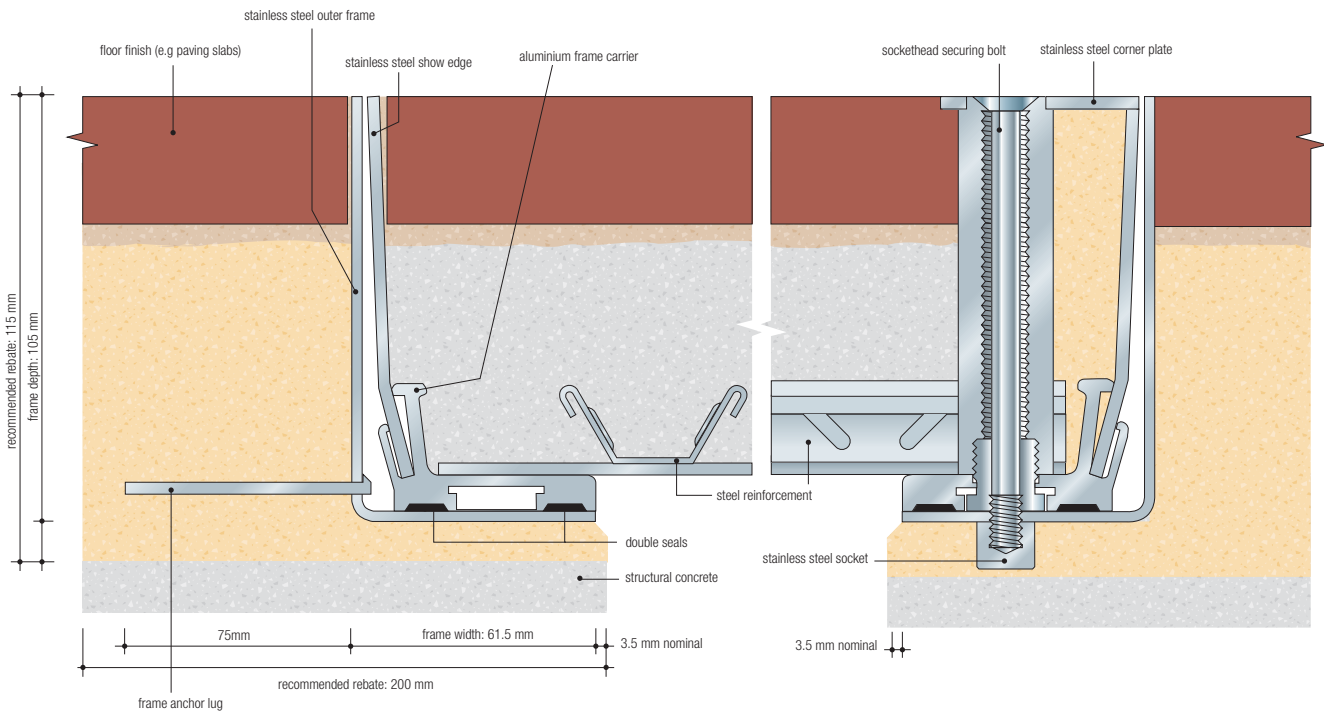

Size

Overall frame size = clear opening + 130 mm e.g. 550 clear opening = 680 mm overall frame width. Subject to correct in-fill/ installation (see separate guide). See also general notes on cover.

Weight

A 1050 series cover when filled with concrete weighs approx. 220 kg/m². See also general notes on cover.

Typical Layout

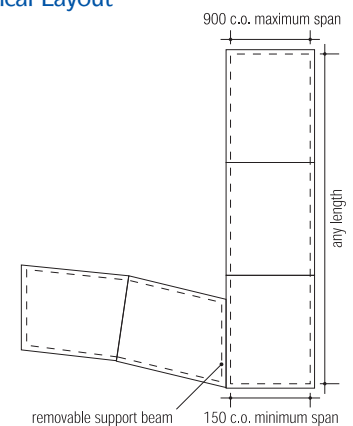



1050 Series Stainless Steel Multipart Cover

Typical floor finishes

External grade paving slabs including granite and concrete.

Performance

Up to 6.5 tonne pneumatic tyre wheel load (C250).

Options

Double seal. Inset lifting points.

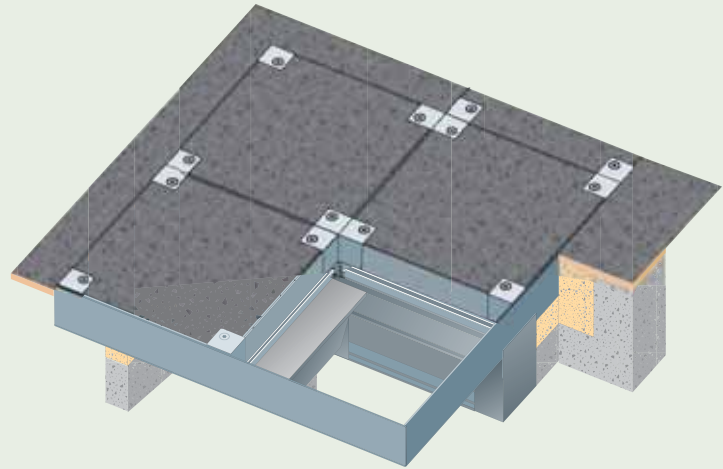

Cross section showing removable support beam and cross members

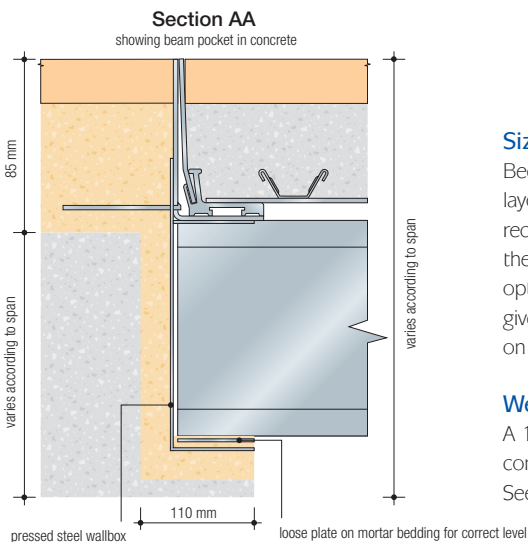
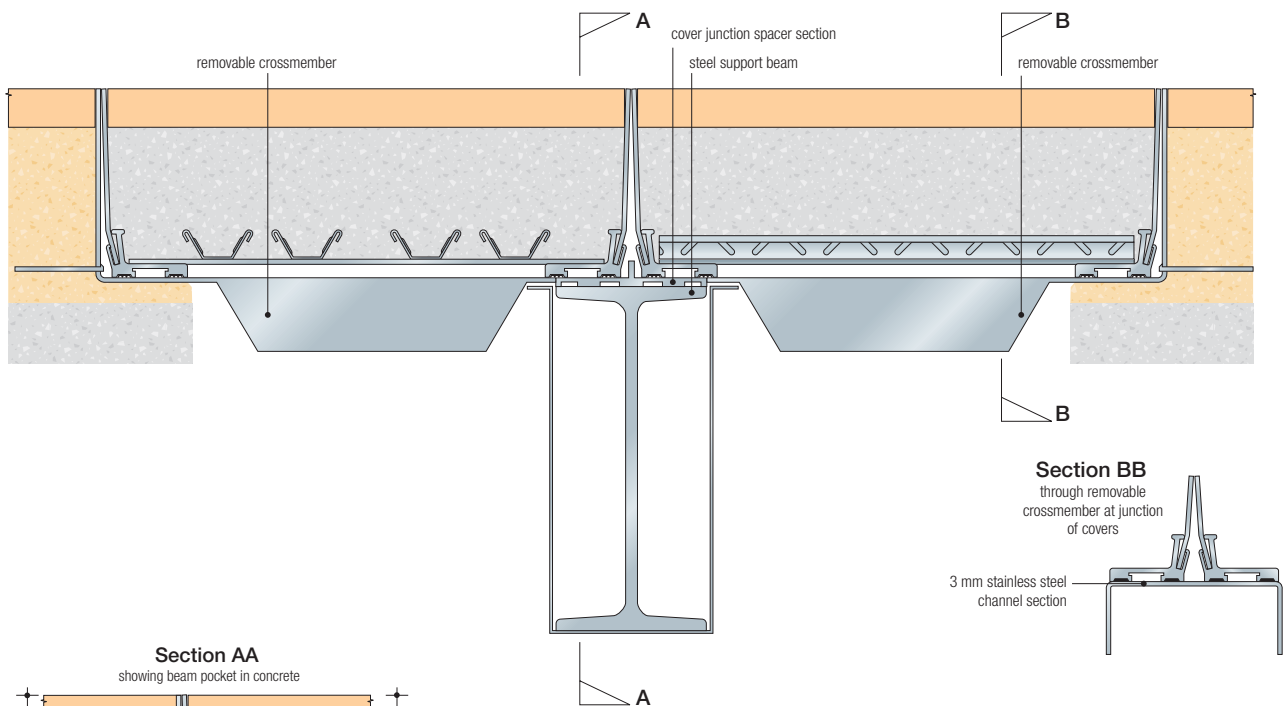

Size

Because of the potentially complex design layout of multipart layouts, Howe Green recommends early consultation with their Technical department to achieve the optimum and economical layout for the given installation. See also general notes on cover.

Weight

A 1050 series cover when filled with concrete weighs approx. 220 kg/m². See also general notes on cover.

Maximum / minimum sizes

